

Technical Data

1.0 PRODUCT

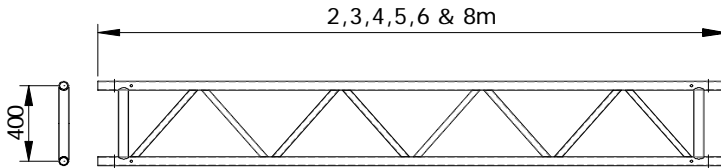

Length (m)	Part Number	Weight(kg)
2	20062000	8.3
3	20063000	12.2
4	20064000	16.2
5	20065000	20.4
6	20066000	24.0
8	20068000	32.2

2.0 GEOMETRY

Overall depth: 448.3mm
 Overall width: 48.3mm

3.0 MEMBERS

	<u>Element</u>	<u>Cross section</u>	<u>Material</u>
Chords:	Upper	CHS 48.3x4.00mm	6082 T6
	Lower	CHS 48.3x4.00mm	6082 T6
Diagonals:	All	RHS 30x20x2.5mm	6082 T6
Struts:	All	CHS 48.3x2.60mm	6082 T6

4.0 PROPERTIES

4.1 MATERIALS 6082 T6

E:	70000 N/mm ²
W:	2710 Kg/m ³
G:	26600 N/mm ²
COE:	23x10 ⁻⁶ per °C

4.2 BEAM

Weight:	4.10 Kg/m
Area:	11.13 cm ²
Iyy:	4481.06 cm ⁴
Izz:	27.53 cm ⁴
J:	4508.59 cm ⁴

5.0 PERFORMANCE

		<u>Lateral restraint interval(m)</u>
Permissible moment:	15.70 KNm	1.0
	8.80 KNm	1.5
	5.40 KNm	2.0
Permissible shear force :	13.50 KN	